

DURAtex
SAINT-GOBAIN
FIBRE CEMENT BOARD

Fibre Cement Solutions

For ceiling, wall and floor

SAINT-GOBAIN



DURAflex
SAINT-GOBAIN
FIBRE CEMENT BOARD



Fire and moisture resistant



Anti-termite



Easy to install



SINGAPORE
GREEN
BUILDING
PRODUCT
S G B C

SGBP 3382



LEADER

DESCRIPTION

DURAflex Fibre Cement Board is an eco-friendly, 100% non-asbestos product made from Portland cement, quicklime, sand, cellulose fibres, and additives. The boards are manufactured under high pressure and accelerated curing to achieve unique characteristics such as superior durability, excellent rigidity, and outstanding moisture resistance.

APPLICATION

DURAflex Fibre Cement Board is widely used for partitions, concealed and T-bar ceilings, internal cladding, and flooring. With its attractive appearance, it is a popular choice among interior designers and contractors, while its exceptional durability and moisture resistance, ensure lasting performance in wet areas and severe duty environments. It is ideal for:

- Moisture-resistant exposed ceilings
- Surrounding walls in humid or high-traffic areas
- Floor underlay applications
- Replacement for tiles, industrial laminated wood, or concrete surfaces

PROPERTIES

Board colour: Light grey colour

Board printing: Reverse - Product name, standard, size, date of manufacture, lot number (for board ≤10mm thick). Edge - Product name, standard, size, date of manufacture, lot number (for board ≥12mm)

STANDARDS

ASTM C1186 - Standard specification for fibre cement sheets. Type B Grade II.



DURAFLEX
SAINT-GOBAIN
FIBRE CEMENT BOARD

BOARD RANGE

THICKNESS (mm)	WIDTH x LENGTH (mm)	EDGE TYPE	SURFACE DENSITY (kg/m ³)	WEIGHT PER BOARD
6.0	1220 x 2440	SE RE	9.1	27.1
8.0	1220 x 2440	SE RE	12.2	36.2
9.0	1220 x 2440	SE RE	13.7	40.7
10.0	1220 x 2440	SE RE	15.2	45.2
12.0	1220 x 2440	SE RE	18.6	55.3
20.0	1220 x 2440	SE	31.6	94.1

RE = Recessed Edge; SE = Square Edge

Note: All weights are approximate.

TECHNICAL INFORMATION

CHARACTERISTICS	VALUE	TEST METHOD
Density	1.25 - 1.45 g/cm ³	ASTM C1185-08
Material Classification	Non combustible	BS 476-Pt 4: 1970
Fire Propagation	Performance index & sub-indices=0,0,0,0	BS 476-Pt 6: 1989
Surface Spread of Flame	Class 1	BS 476-Pt 7: 1997
Moisture Content	8 - 10 %	ASTM C1185-08
Moisture Movement	0.01 - 0.07 %	ASTM C1185-08
Water Absorption	<35 %	ASTM C1185-08
Average Flexural Strength	14 - 16 MPa	ASTM C1185-08
Impact Strength	10 - 14 J	JIS A 1408: 2001
Delamination	Non-delamination	
Screwing Resistance (Level)	Being unbreakable when screwing shooting	
Thermal Conductivity	0.166 W/mk	

APPLICATION ILLUSTRATIONS

Civil steel frame houses

Coffee shop

Factory

Showroom

DURftex
SAINT-GOBAIN
FIBRE CEMENT BOARD

EXPOSED CEILING TILES

DURAflex exposed ceiling tiles are moisture resistant and fireproof, making them the ideal choice for moisture-resistant and heat-prone environments. Perfect for factories, offices, commercial buildings and residential homes, they deliver lasting performance in demanding conditions.

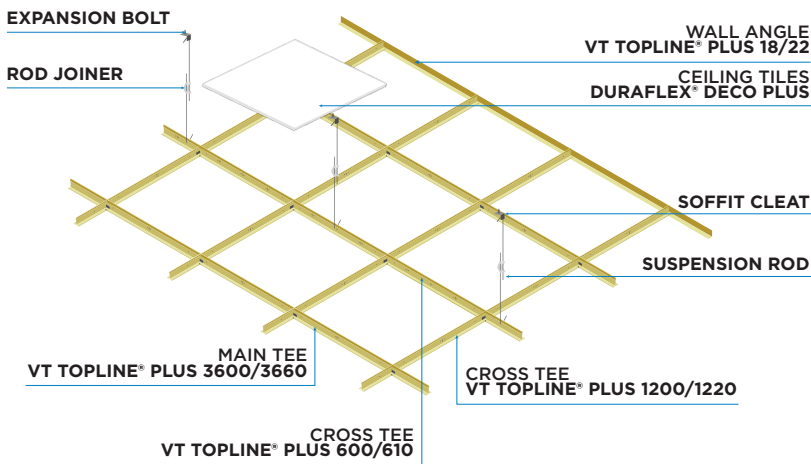

PRODUCT INFORMATION

Thickness

- 3.0mm
- 4.0mm
- 6.0mm



DURAftex
SAINT-GOBAIN
FIBRE CEMENT BOARD

How to install Exposed Ceiling using DURAf^{flex} Boards

Determine the ceiling height where the suspended ceiling will be installed. Fix wall angle to the wall using nails or other suitable fasteners. Install the suspension rod to the main runner. Mark the cross runner positions based on the selected ceiling layout. Install the cross runner by inserting their ends into the slots on the main runner.



Place the board on the cutting table and measure the required size according to the ceiling grid. Use a specialised cutting knife to score a deep cut along the marked line. Position the cut line at the edge of the cutting table, holding the board firmly with one hand while pressing down on the overhanging edge with the other to snap it cleanly.



Drop the ceiling tiles into position by tilting them slightly, following the printed arrows on the back of the boards to ensure a uniform appearance. Lift each tile above the framework and gently lower it into place.



Clean the surface of the boards after installation on the frame. Complete the ceiling with final decorations. Hang lights or other decorative objects following the manufacturer's recommendations.



INTERIOR WALL/ PARTITION

DURAFlex Fibre Cement Board offers superior durability, sound insulation, and resistance to moisture and fire. Designed for interior applications such as walls and partitions, it provides an efficient alternative to traditional brick and cement wall systems, which typically require longer construction times, especially in high-rise building projects. Ideal for partitions in offices, trade centres, residential buildings, and hotels, DURAFlex Fibre Cement Board is also well suited for wet areas like kitchens, bathrooms, and cold storage warehouses thanks to its excellent moisture resistance, making it ideal for harsh climate conditions.

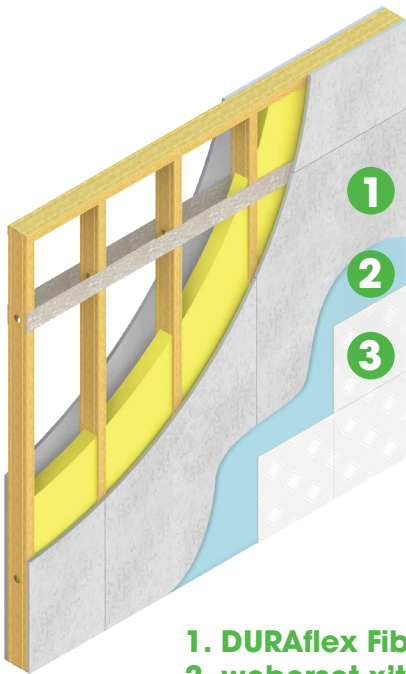

1. DURAFlex Fibre Cement Board
2. weberset x'tra flex
3. Tiles

PRODUCT INFORMATION

Thickness

- 6.0mm square edge
- 9.0mm square edge
- 8.0mm square edge
- 10.0mm square edge

PRODUCTS	DIMENSIONS (mm) (Width x Length x Thickness)	WEIGHT (kg/sheet)
DURAFlex Fibre Cement Board 6mm (SE)	1220 x 2440 x 6	28
DURAFlex Fibre Cement Board 8mm (SE)	1220 x 2440 x 8	37
DURAFlex Fibre Cement Board 9mm (SE)	1220 x 2440 x 9	42
DURAFlex Fibre Cement Board 10mm (SE)	1220 x 2440 x 10	46

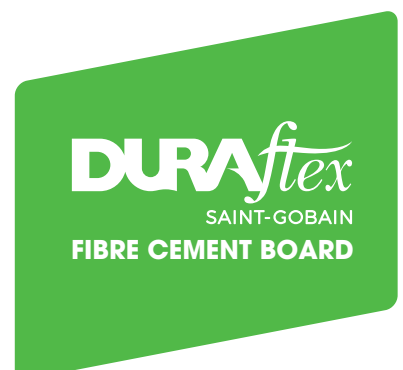

How to install DURAf^{flex} Boards for partitions

Determine the installation position for the metal frame. Fix the U-Track to the floor and soffit at 600 mm centres using suitable fixings. Position the C-Stud within the U-Track at 610* mm spacing and secure with wafer head screws. Install M&E services after boarding one side of the frame.



*For wet areas with marble or tiling, use 406 mm spacing.

For normal joints, cover screw heads and joints with a specialised joint compound.
 For open joints, use a modified silicone sealant.



Secure boards to the metal frame with screws, leaving a 2–3 mm gap between boards and staggering joints. Space screws at max. 300 mm centres along every C-Stud, and no closer than 10–12 mm from the board edges and ends. For 3.6 m wall height, include one open joint of 4–5 mm width.

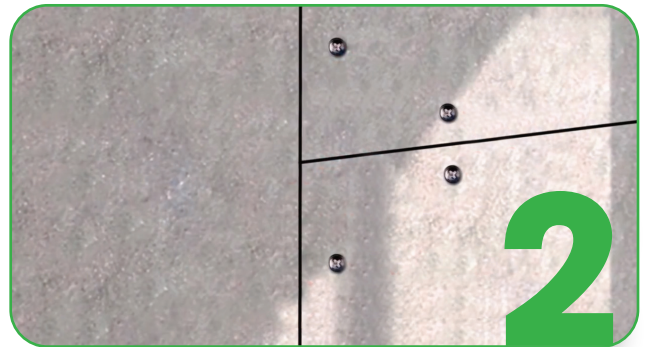

Cover the board surface with water-based paint, wallpaper, or tiles. For max. tile loading capacity, please consult our technical team. To hang heavy objects, use suitable fixings. DURAf^{flex} Boards 8 mm can withstand 30–40 kg per point.

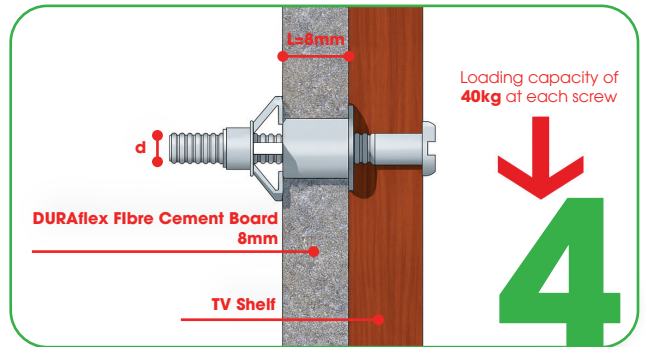

FLOOR UNDERLAY

DURAflex Fibre Cement Boards are plain cement boards designed as a durable alternative to concrete or laminated wood flooring. Featuring superior strength, effective moisture resistance, and fire resistance, they are easy to install for floors in mezzanines, factories, offices, commercial buildings, residential homes, and industrial structures. Boards of 8–9 mm thickness can be used as ceiling tiles to replace concrete roofs.

PRODUCT INFORMATION

Thickness

- 12.0mm square edge
- 16.0mm square edge
- 18.0mm square edge
- 20.0mm square edge

PRODUCTS	DIMENSIONS (mm) (Width x Length x Thickness)	WEIGHT (kg/sheet)
DURAflex Fibre Cement Board 12mm (SE)	1220 x 2440 x 12	55
DURAflex Fibre Cement Board 16mm (SE)	1220 x 2440 x 16	74
DURAflex Fibre Cement Board 18mm (SE)	1220 x 2440 x 18	83
DURAflex Fibre Cement Board 20mm (SE)	1220 x 2440 x 20	93

DURAflex
SAINT-GOBAIN
FIBRE CEMENT BOARD

DURAf^{te}x
SAINT-GOBAIN
FIBRE CEMENT BOARD



Saint-Gobain Malaysia
Level 19, Tower 5,
Avenue 7 The Horizon,
Bangsar South, 59200,
Wilayah Persekutuan Kuala Lumpur,
Malaysia
www.saint-gobain.my

Saint-Gobain Singapore
2 Venture Drive, #13-18,
Vision Exchange,
Singapore 608526
www.saint-gobain.sg

The images provided are for reference only. Kindly obtain confirmation from Saint-Gobain Technical Support Team before submission of specification for any project. The information in this literature is accurate at the time of publishing. The publisher reserves all rights to revise the product specifications without prior notice. It is the user's responsibility to ensure that the information communicated here is current before use and that the information provided here is for guidance only. Users must ensure that they are fully conversant with the products and systems before specification or installation.

Version: DURAf^{te}x Fibre Cement Board v08.2025